

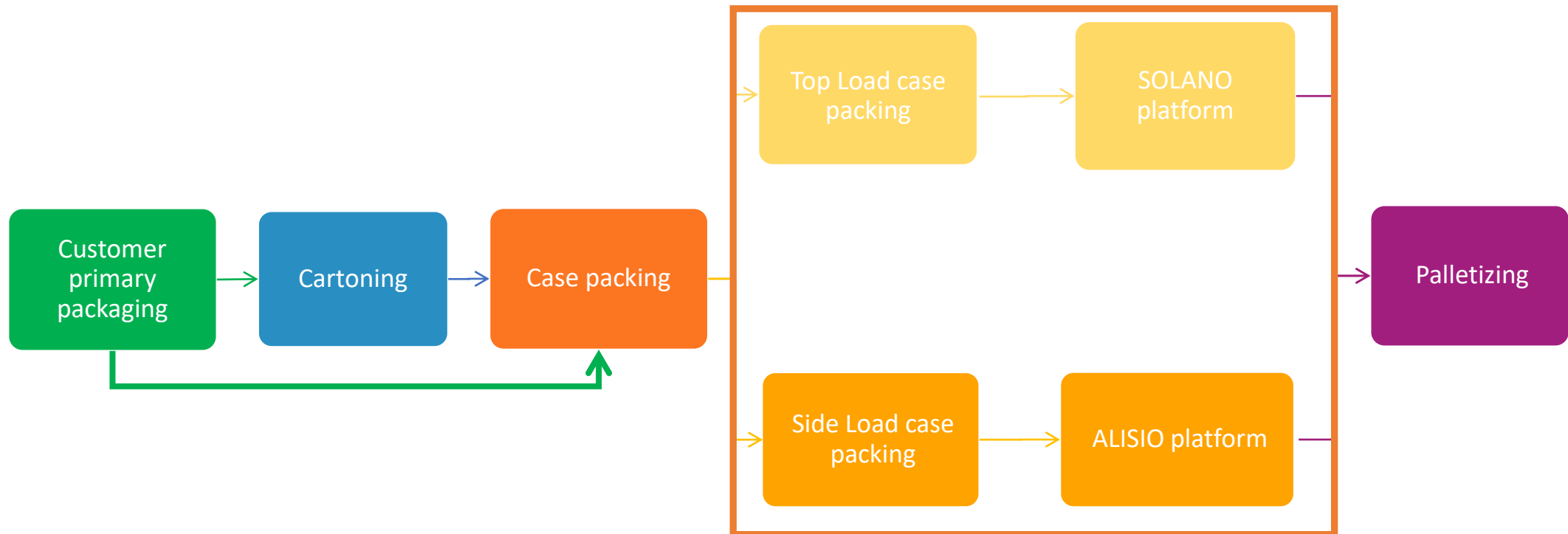

Limitless Packaging Automation

Full packaging line solutions



Full Packaging Line Solutions

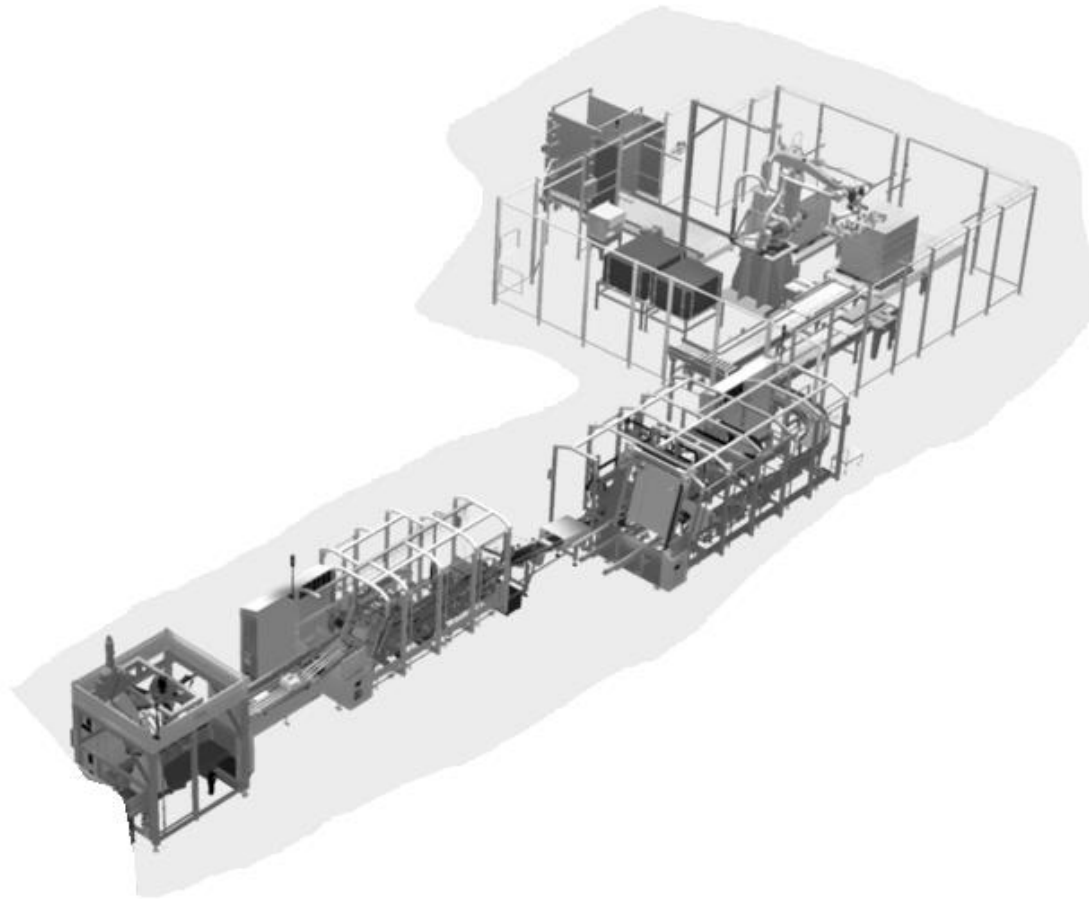

Side Load Cartoning Platform

- VENTO & MAESTRO platform
 - Continuous and indexing
- Design
 - Robust; Stainless steel, servo driven eliminating wear parts
 - Hygienic; Open and no flat surfaces for accumulating waste
 - Easy access; open and easy to reach parts
- High-speed, up to 500 cartons per minute
- Flexible
 - Carton sizes; wide range of carton dimensions
 - Product formations; Solutions designed to load single and multiple products, Flat on edge.
 - Fast change over; Servo driven automatic pre programmed tool less change over within 5 minutes



Side Load Cartoning Platform

- Very good carton handling
 - Infeed section with pre break solution can handle recycled quality cartons
 - Special Lug track can handle glossy cartons without scratching them
- iMi
 - Touchscreen
 - Reporting tools
 - Traceability of products
 - Auditability based on CFR21 part 11.
 - Industry 4.0 package
 - Easy connectivity to other machines in complete line

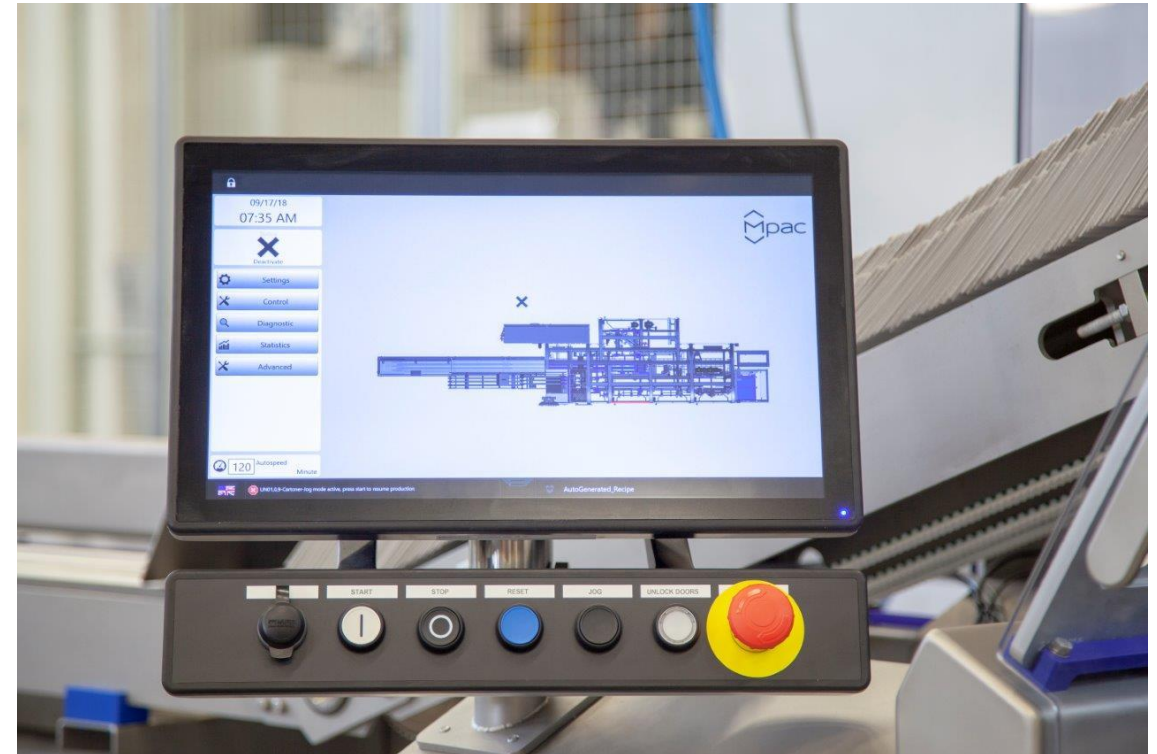

ALISIO Side load casepacker

- The ALISIO side load case packer can be used to load
 - RSC cases
 - Wrap Around cases
 - Optional module for retail ready cases
- Speed up to 25 cpm
- Fast change over
 - <10 minutes to change formats and case types
 - Tool less

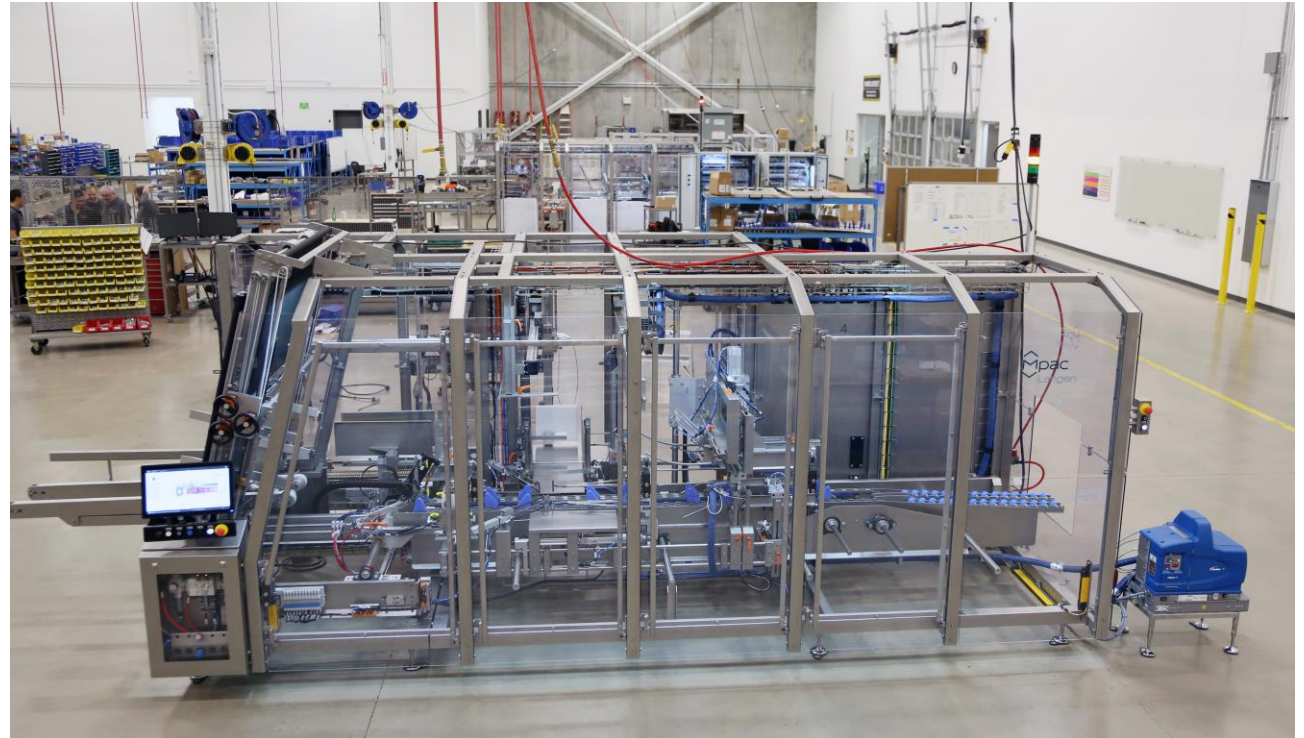

SOLANO Top load case packing platform

SOLANO SL (Single Load > Standard with integrated case-erector and loading 1 case.

- 15 cpm
- RSC and HSC



SOLANO ML (Multiple load > Cell to load multiple cases without case-erector)

- >15 cpm
- RSC and HSC

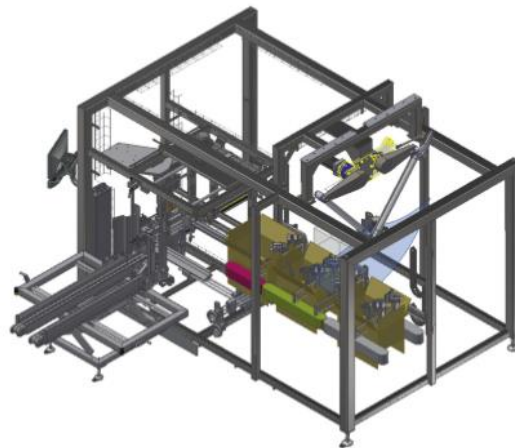

SOLANO SC (Single cell > Standard for loading the bucket conveyor of a cartoner.

- >15 cpm
- RSC and HSC



SOLANO CM (Continuous loading > no integrated case-erector to load a case in continuous motion)

- >15 cpm
- RSC and HSC



LRC 600 Robotic Palletiser

- Robotic palletiser
- Multiple configurations
 - 1 to multiple robots working together
- Options
 - Shrink wrapper
 - Labeller
 - Printer



Standard Infeeds for specific applications

- Flex pickers (Confectionary)
- Bombay (sticks/sachets)
- Starwheel (bags/sachets)

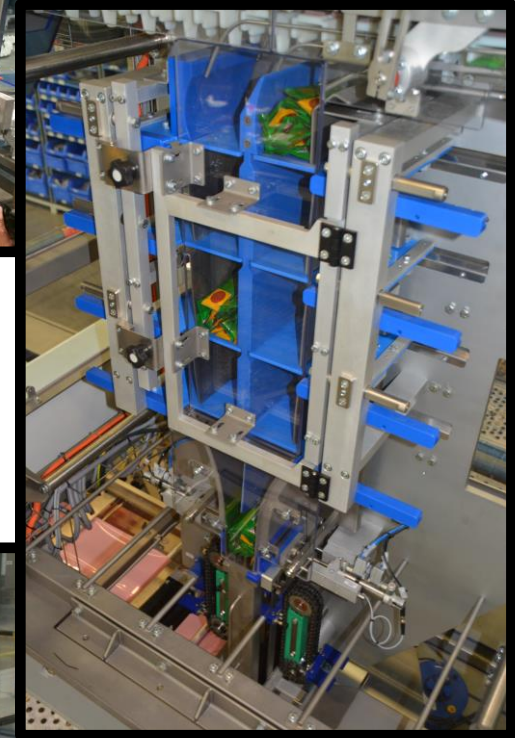

Full Packaging Line Solutions

- › Modular solution based on our standard machines and infeeds
 - MAESTRO & VENTO cartoners
 - SOLANO & ALISIO case packers
 - LRC 600 Palletiser
- › Depending on product, Solution is engineered
- › Additional options
 - Check weighers
 - Label/spoon infeed systems
 - Printers/labellers
 - Track and Trace

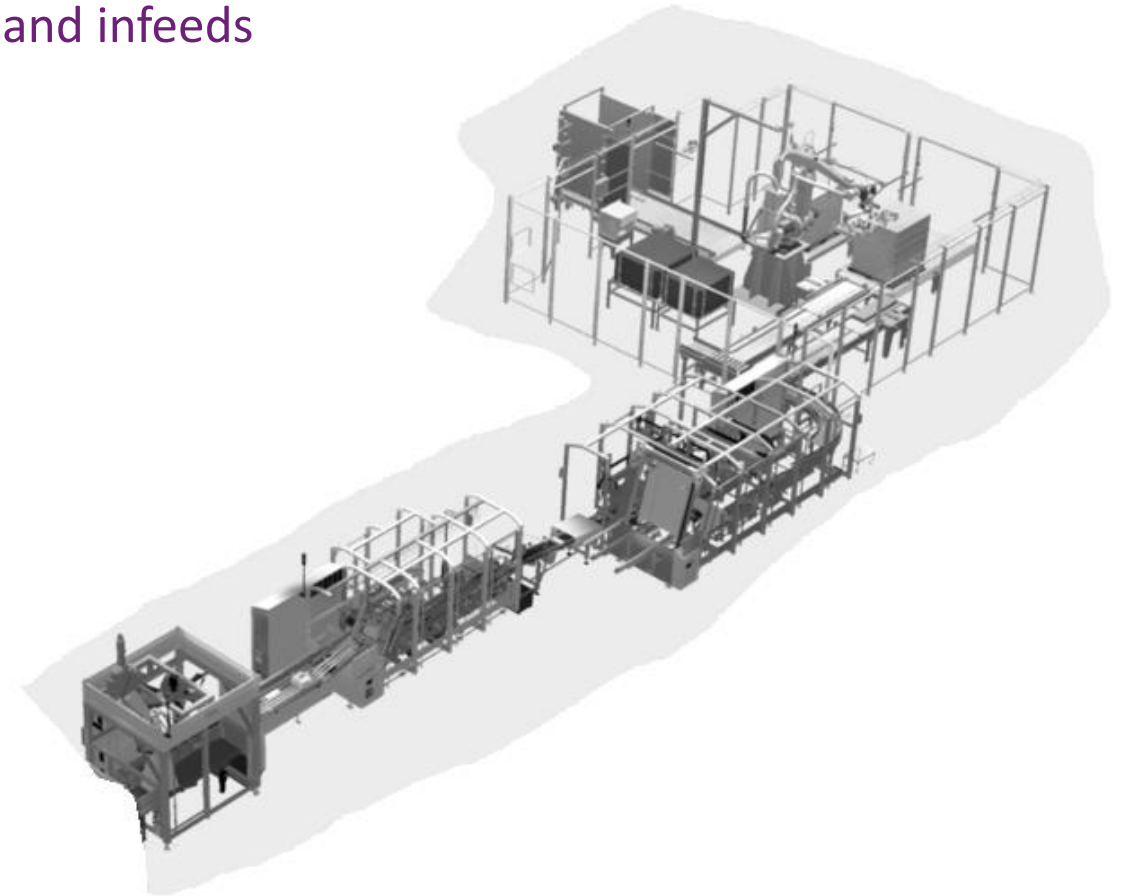

Track & Trace

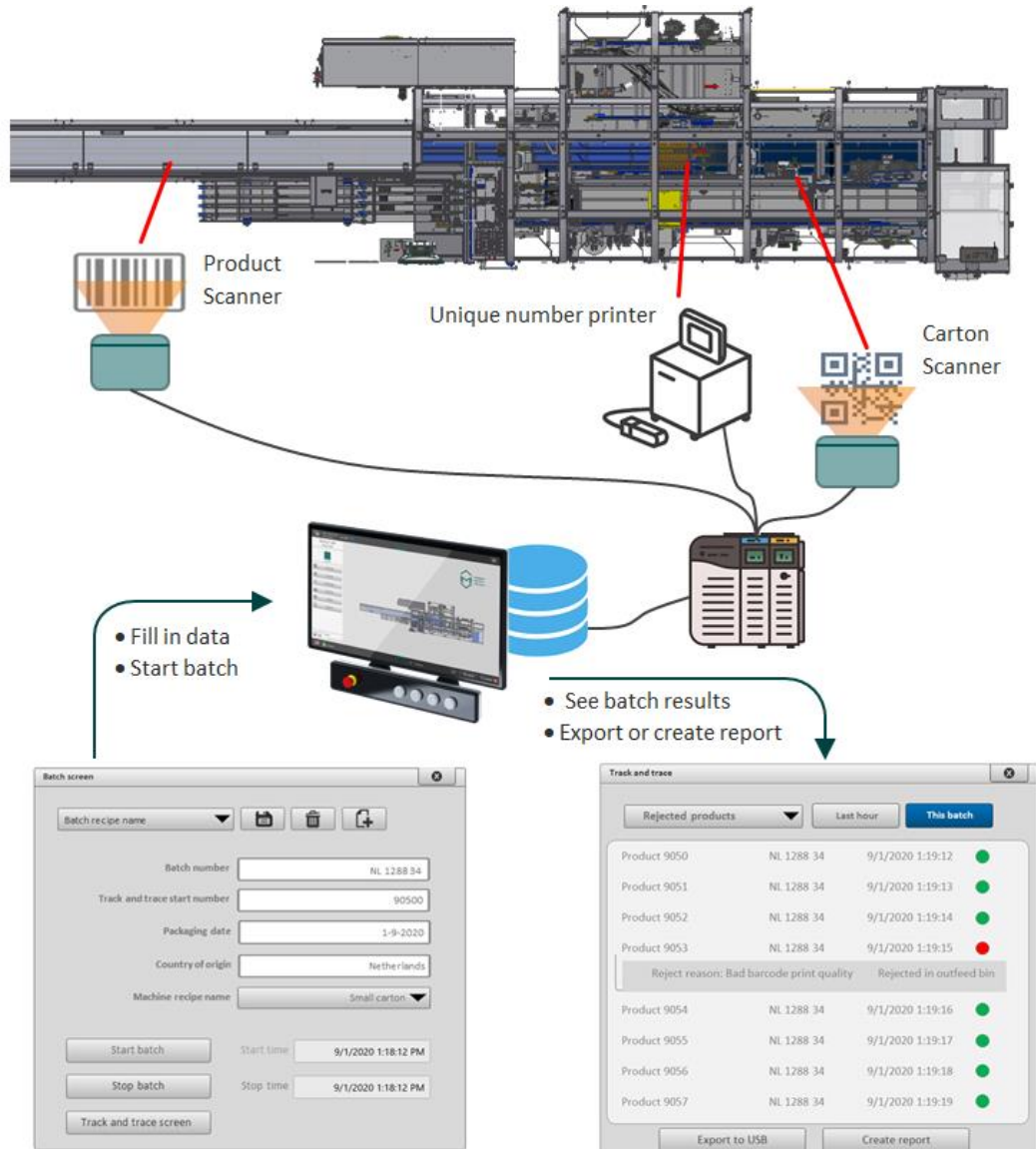

> 5 levels

- Level 1 is hardware (scanners, vision systems, printers).
- Level 2 is software to control the level 1 hardware and to communicate with the level 3 software.
- Level 3 is software to allocate serial numbers
- Level 4 is software that manages and verifies the data that must accompany each serial number
- Level 5 is a network that manages all regulatory data and serial numbers with partners, customers and authorities.

> CFR21 part 11 is FDA regulatory that describes which data has to accompany the serial numbers

- In iMi we have an option for a database that gives this additional data, like track changes, time of change , etc.

Full Packaging Line Solutions

- › A full packaging line solution is not just putting a few packaging machines behind each other.
- › It has to be engineered and installed as 1 complete system; Full line control
- › All parts in this system need to work flawlessly together, from cartoning machines and case packers to vision systems, printers, labellers and check weighers



- › Depending on product, Full packaging line solution is engineered
- › Worry free installation and support of full packaging line
 - 1 point of contact
 - 1 validation, 1 FAT; Whole line tested before shipping so 1 project management
 - 1 service point of contact

Full Packaging Line Solutions

- › In-depth knowledge on communication between machines in line
 - Synergy and therefore cost efficiency
- › iMi connects all machines and options into 1 system, resulting in
 - easy to operate packaging line
 - high OEE
 - easy to plan correct maintenance schedules for the complete line





Full Packaging Line Solutions



Thank you for attending

We are looking forward to see you again on Thursday November 12 from 9.00 to 10.00
CET for our next live session on

Industry 4.0